



INTRODUCING THE TRAILS OF COUNTRY LANE

Offering unprecedented value to today's new home buyer, the Classic Collection features fabulous fully detached homes. With "Heathwood Included", each is appointed with an amazing array of luxury features and upgrades...all included in the standard purchase price of your new Country Lane home!



EXQUISITE EXTERIOR DETAIL

- | | |
|--|---|
| 1. Classic brick and stone façade with exquisite stone detailing | 5. Green Home Wall System – insulated to R26 |
| 2. 8' Fiberglass front door with luxurious passage set | 6. R55 Attic insulation – to keep you warm and save you money |
| 3. Maintenance free, Low E argon-filled vinyl casement windows | 7. Fully insulated sectional garage doors |
| 4. Articulated fiberglass shingles with manufacturer's lifetime limited warranty | 8. Soffit lighting |
| | 9. Landscaping package |



THE TRAILS OF COUNTRY LANE

- 1 Upgraded kitchen cabinets with extra height uppers in a choice of style & colour **
- 2 Deep upper cabinets over fridge with top drawers on lower cabinets*
- 3 Soft close doors and drawers in kitchen, as per plan
- 4 Flush breakfast bar in 1 1/2" granite built up square edge **
- 5 Granite counter tops 1 1/2" built up square edge
- 6 Ceramic backsplash
- 7 Stainless Steel canopy hood fan over stove area **
- 8 Easy to clean under mount double stainless steel sink with upgraded single lever tap and vegetable spray.**
- 9 Choice of 20 4" pot lights on main floor and finished lower level*
- 10 Recess pot lights on front elevation, as per plan*
- 11 Oversized 8ft high main entry door system, some with side lites*
- 12 Automatic light in foyer closet*
- 13 Programmable set back thermostat*
- 14 Direct vent gas fireplace with painted wood mantle and Marble surround **
- 15 Metal pickets or Oak pickets choice of finish & oak handrail in Choice of finish
- 16 9ft ceilings on main floor & 8ft ceilings on 2nd floor*
- 17 Approximately 9ft ceilings in lower level except where support beams and ducting located*
- 18 5" Pre-finished vintage sculpted oak strip flooring throughout main floor and upper hall in choice of colours (except tiled areas)*/**
- 19 Oak stairs from main to 2nd floor and main to Lower Level in choice of stain finish
- 20 Upgraded satin nickel front door grip set and deadbolt
- 21 5 1/4" baseboards & 3" integrated backband casings throughout finished areas*
- 22 Easy maintenance smooth ceilings on main floor and finished laundry rooms*
- 23 Sprayed stipple ceiling with 4" smooth borders in all other rooms except rooms with cathedral ceilings*
- 24 8ft high 6 panel style swing interior safe and sound doors on main floor & standard height 6' 8" 6 panel safe and sound swing doors on 2nd floor and finished areas in lower level*
- 25 Upgraded Vanity cabinetry in all bathrooms with Arborite counter tops, some with top drawer except powder room*
- 26 Frameless glass shower enclosures with door in master ensuite*
- 27 Water saving dual flush toilets
- 28 Garage door opener with remote control
- 29 Sectional insulated garage doors, style per plan
- 30 Complete Beam Central Vacuum System
- 31 Finished lower level with 3 piece bathroom*
- 32 Fully insulated exterior walls to R26 and Attic to R55
- 33 96% High efficiency forced air gas furnace with ECM Motor
- 34 Heat Recovery Ventilator (HRV)
- 35 Humidifier
- 36 Air Conditioning
- 37 Stainless Steel Fridge, Stove, and Dishwasher
- 38 White Front Loading Washer/Dryer
- 39 HEATHWOOD TOTALHOME+

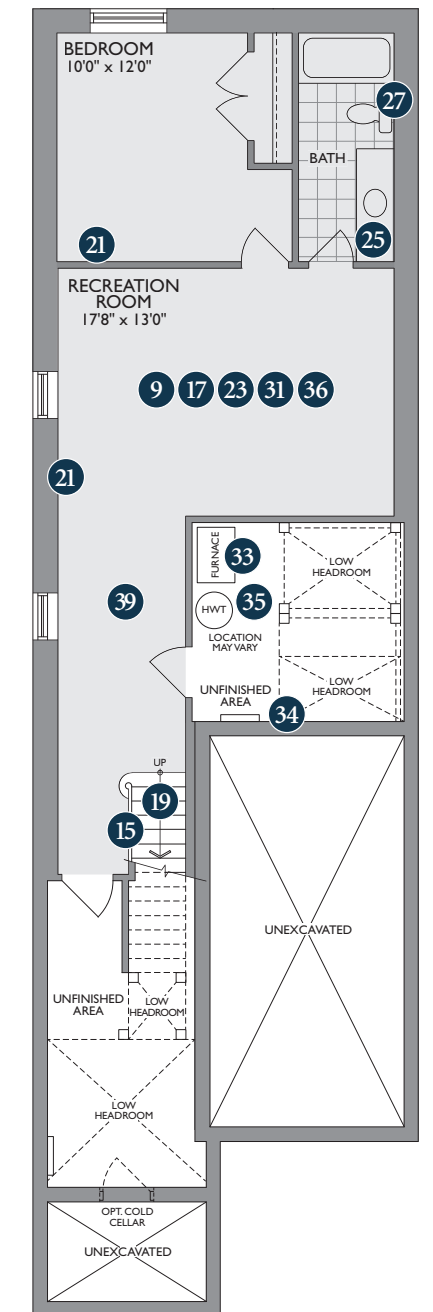
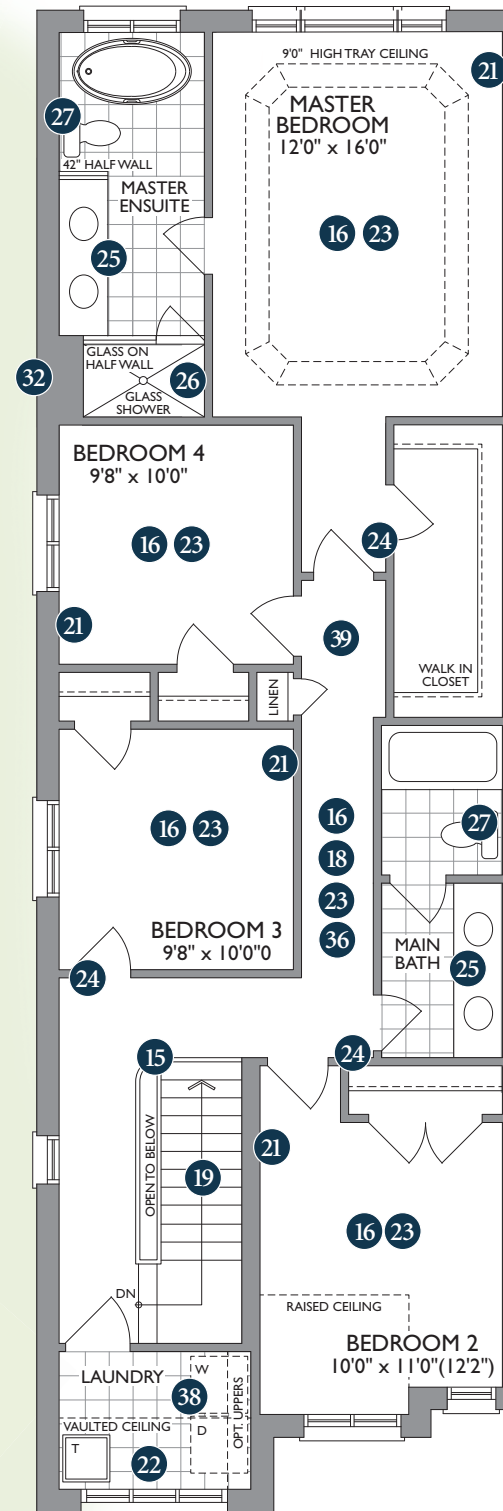
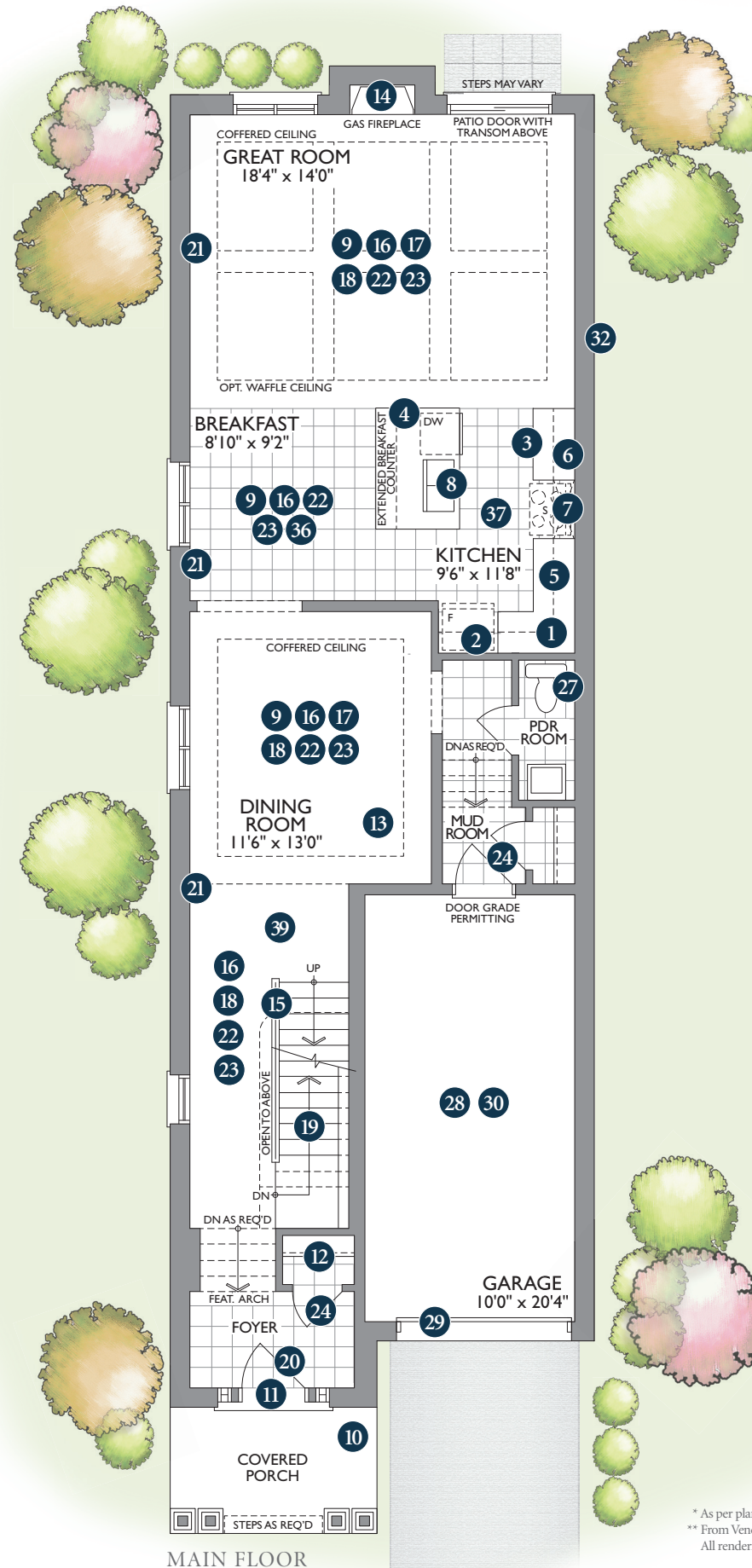

SECOND FLOOR

LOWER LEVEL

MAIN FLOOR

* As per plan.
** From Vendors standard samples. Dimensions, specifications and architectural detailing are subject to changes without notice E. & O.E.
All renderings and landscape features are artist's concept. February 2020.



(647) 287-7042
heathwoodcountrylane.com

